

P.E. STAMP

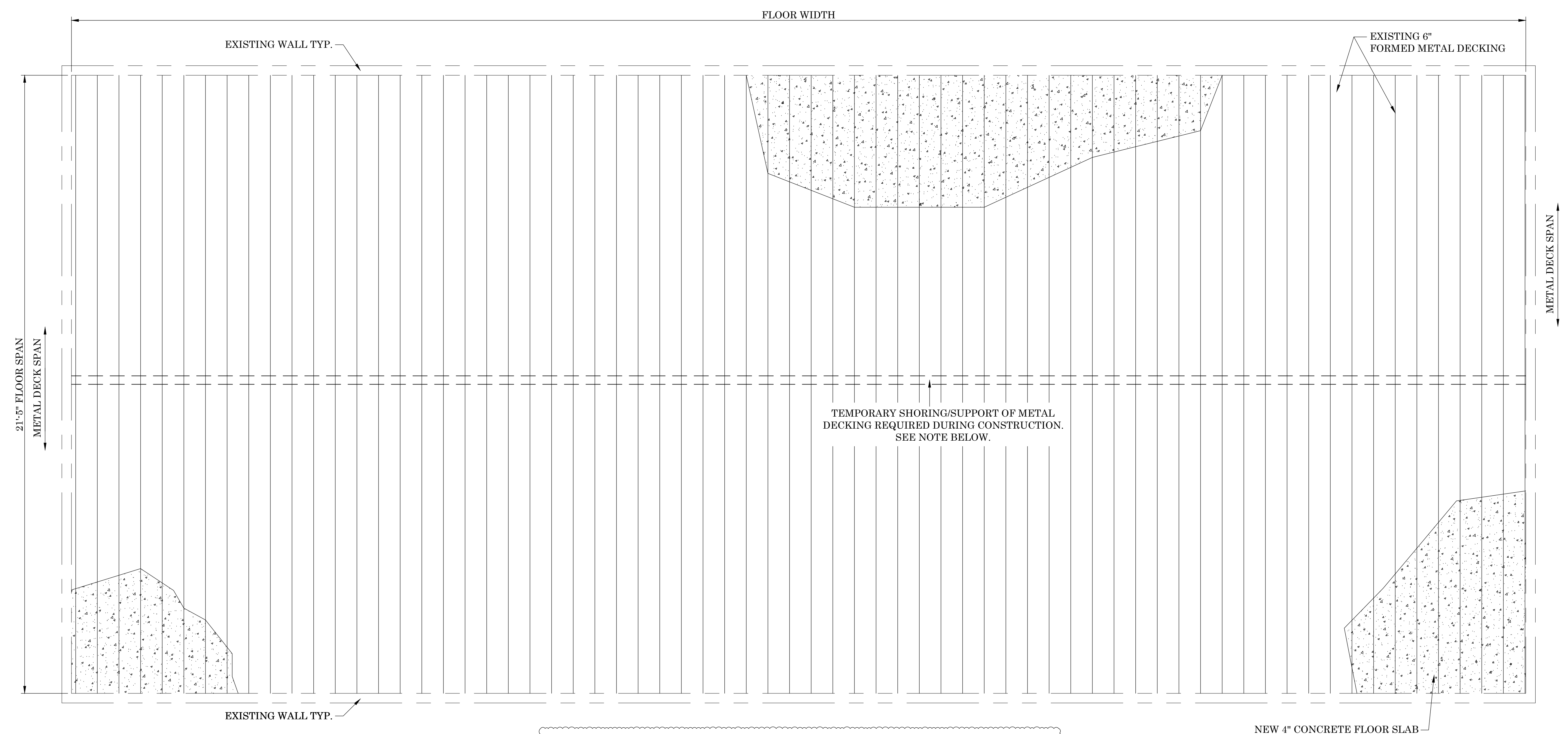

NOTE: MAXIMUM SPAN OF METAL DECKING DURING CONSTRUCTION/PLACEMENT OF CONCRETE FLOOR IS 12'-0" OR LESS TO PREVENT SAG. IF THE DECKING SPAN IS LONGER THAN 12'-0", TEMPORARY SHORING MUST BE PLACED BENEATH UNTIL CONCRETE HAS CURED.

PLAN VIEW OF EXISTING METAL DECKED FLOOR

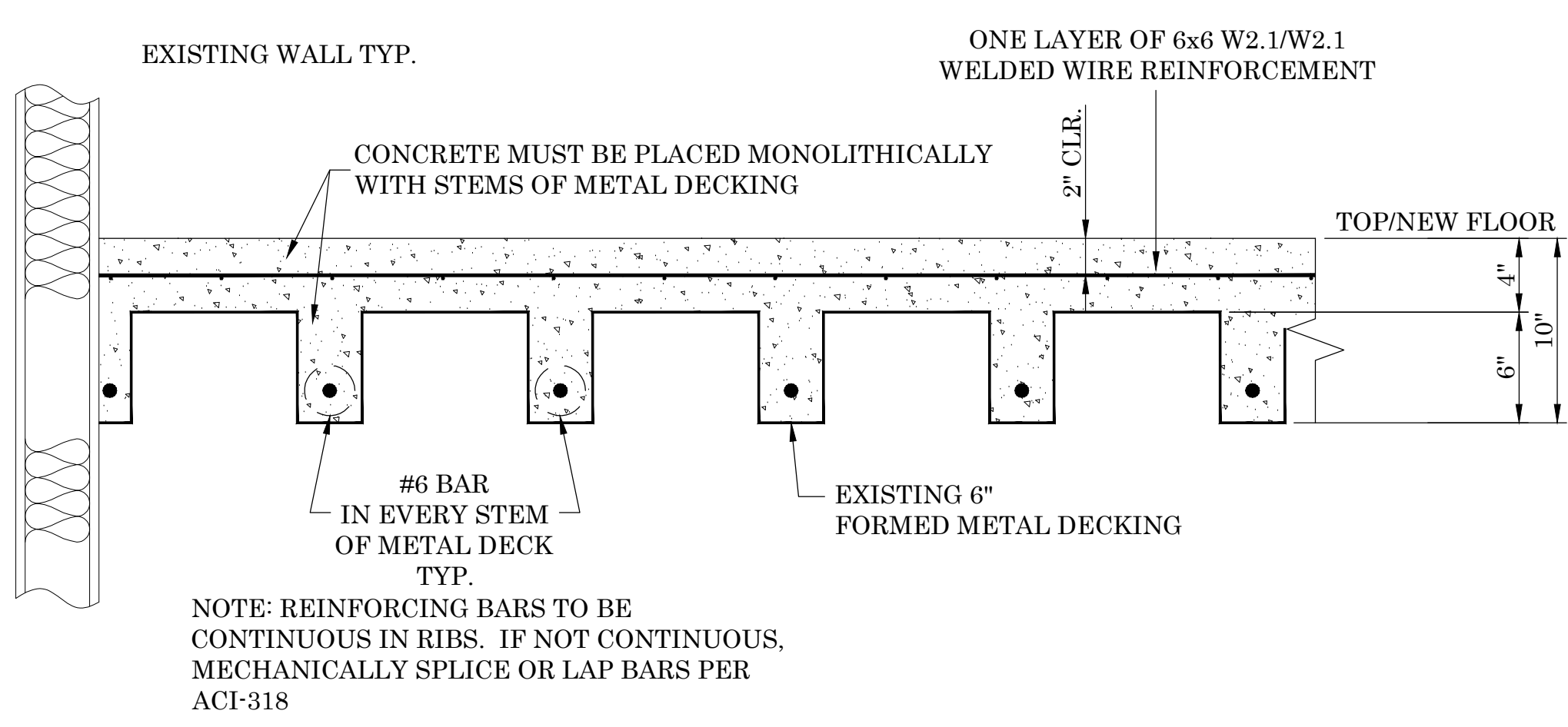

TYPICAL SECTION OF NEW CONCRETE FLOOR

SCALE: 1 1/2"=1'-0"

DESIGN ASSUMPTIONS:

- 1) ALL EXISTING METAL DECKING IS PROPERLY ATTACHED TO THE ADJACENT PANEL.
- 2) ALL EXISTING METAL DECKING IS PROPERLY SUPPORTED AT EACH END PER THE MANUFACTURERS REQUIREMENTS.
- 3) OWNER TO VERIFY THAT ALL METAL DECKING IS PROPERLY INSTALLED AND CAPABLE OF ACCEPTING THE NEW CONCRETE FLOOR.
- 4) THE SUPPORTING WALLS AND THEIR FOOTINGS ARE PROPERLY SIZED TO SUPPORT THE WEIGHT OF THE NEW FLOOR AND THE OCCUPANCY LOAD.

DESIGN CRITERIA:

- 1) FLOOR LIVE LOAD = 50 PSF (OFFICES PER VIRGINIA BUILDING CODE)
- 2) FLOOR DEAD LOAD = 84.1 PSF (CONCRETE AND DECKING)
- 3) FACTORED DESIGN LOAD = 180.92 PSF
- 4) DEFLECTION LIMIT = L/360 LL AND L/240 LL +DL

GENERAL NOTE:

- 1) ALL EXISTING METAL DECKING MUST BE LEVEL W/ NO DEFLECTION OR SAG PRESENT BEFORE AND AFTER PLACING OF CONCRETE. ENSURE PROPER TEMPORARY SUPPORT OR SHORING IS PROVIDED DURING CONSTRUCTION TO PREVENT NEGATIVE CAMBER FOR WHICH THE FLOOR ISN'T DESIGNED FOR.

CONCRETE NOTES:

- 1) ALL CONCRETE TO HAVE A 28 DAY COMPRESSIVE STRENGTH (F_c) OF 4000 PSI MIN. OWNER TO BE PROVIDED A COPY OF THE MIX DESIGN FROM THE SUPPLIER.
- 2) CONTRACTOR TO PERFORM SLUMP AND AIR TEST AS REQUIRED TO CONFIRM MIX DESIGN FROM SUPPLIER BEFORE PLACING CONCRETE.
- 3) ALL REINFORCING BARS TO BE GRADE 60 AND FREE OF RUST, OIL, GREASE OR ANY OTHER COATINGS PRIOR TO PLACEMENT.
- 4) ALL CONCRETE SHALL MEET THE REQUIREMENTS OF THE LATEST EDITION OF ACI 318.
- 5) ALL HOT WEATHER CONCRETING SHALL BE IN ACCORDANCE WITH THE LATEST EDITION OF ACI 305R.
- 6) ALL COLD WEATHER CONCRETING SHALL BE IN ACCORDANCE WITH THE LATEST EDITION OF ACI 306.

DATE:	
REVISIONS:	

PROJECT:	
CLIENT NAME:	

DRAWING TITLE:	
DRAWING DESCRIPTION:	
SCALE:	
DRAWN BY:	
PROJECT NUMBER:	
ISSUE DATE:	
DATE:	
PROJECT LOCATION:	

DRAWING REVISION

DRAWING NUMBER